

Ballet Lubbock

The Four Seasons

Handbook

2024

QUESTIONS:

Volunteering:

Sydney Rood

sydney@balletlubbock.org

804-572-9405 - text

General Information, Illness During Theatre Week:

Micah Collier

production@balletlubbock.org

806-790-5401 – text

TABLE OF CONTENTS

I. CASTING INFORMATION & PERFORMANCE SCHEDULE.....	3
A. Performance Casts.....	3
B. Performance and ticket information.....	3
C. Performance Cast in Order of Appearance.....	4
II. DETAILED REHEARSAL & PERFORMANCE SCHEDULES.....	6
A. Pre-Theatre Week Rehearsal Schedule.....	7
B. Theatre Week Schedule.....	8
III. STUDENT INFORMATION.....	9
A. Check-In/Out Locations & Procedures.....	9
B. Student Needs at Buddy Holly Hall.....	9
C. Costume, Makeup & Hair Assignments.....	10
IV. GENERAL INFORMATION.....	11
A. Attendance of Theatre Week Rehearsals.....	11
B. Ticket Information.....	11
C. Photography & Video Information.....	11
D. Buddy Holly Hall Information.....	11
V. MAP	12

I. CASTING INFORMATION & PERFORMANCE SCHEDULE

A. PERFORMANCE CASTS

- There is one performance cast.
- Consistent and punctual attendance at rehearsals and performances is required.
- Any conflict due to a graded, school-mandated requirement needs to be discussed with the Assistant Artistic Director (Lily@balletlubbock.org) as soon as the conflict becomes known to the student.
- If a student must miss a rehearsal due to an illness or family emergency, it is the responsibility of the parent/guardian to notify Micah Gonzales in writing via email (production@balletlubbock.org) prior to the rehearsal or performance.

B. PERFORMANCE AND TICKET INFORMATION

The Four Seasons will be performed on Saturday, April 13th at 7:30pm at:

Buddy Holly Hall of Performing Arts and Sciences: Helen DeVitt Jones Theatre, 1300 Mac Davis Ln. (See map, pg. 13)

- To purchase tickets please visit www.balletlubbock.org or <https://www.buddyhollyhall.com>
- You may also call (806) 79-BUDDY (792-8229) or visit in person at the Buddy Holly box office, located at 1300 Mac Davis Lane, Lubbock, TX 79401.
- The Buddy Holly Hall does NOT allow children to sit on an adult's lap. **Each person MUST have a seat/ticket.**

C. PERFORMANCE CAST IN ORDER OF APPEARANCE

ACT I - MOONLIGHT

MALE FEATURED DANCER:

Noble Nguyen

FEMALE FEATURED DANCERS:

Hope Acrey

Maya Al-Hmoud

Xaria Atienza

Talitha Dalton

Evelyn Fisher

Alexandria Flores

Liliana Hale

Brooke Lieberman

Catherine Lituania

Bridget Mitchell

Charity Neel

Addison Reynolds

Katy Jane St. Clair

(Understudies: Kyrie Gutierrez, Viviana Luevano, Brynna Reimer, Emma Saculo)

ACT II - THE FOUR SEASONS

LEVEL 6 ATTENDANTS:

Mia Adams

Cana Dalton

Variya Davis

Angelica Guel

Maesyn Lane

Jessie Olivo

Hope Parker

Mamie Jane Rye

Ella Smith

Carly Soderstrum

FOUR SEASONS – SPRING

SPRING LEADS:

Alexandria Flores

(Understudy: Addison Reynolds)

Noble Nguyen

SPRING DEMI-SOLOISTS:

Xaria Atienza

Brooke Lieberman

Catherine Lituania

Addison Reynolds

(Understudy: Katy Jane St. Clair)

FOUR SEASONS – SUMMER

SUMMER LEADS:

Evelyn Fisher

Charity Neel

(Understudy: Bridget Mitchell)

SUMMER CORPS: LEVEL 7

Jade Achin

Leilah Alvarez

Samantha Borrego

Nadia Byrd

Simeon Dalton

Charlee Kay Jaynes

Audrey Oaks

Gemma Reber

Avett Reynolds

Ashlee Rodriguez

Marsali Soonpaa

Molly Thompson

FOUR SEASONS – AUTUMN

AUTUMN LEAD:

Katy Jane St. Clair *(Understudy: Maya Al-Hmoud)*

AUTUMN CORPS: LEVEL 8

Kyrie Gutierrez

Julia Lopez

Viviana Luevano

Anna Belle Needham

Brynna Reimer

Ruth Rocha

Emma Saculo

Alexandra Wells

(Understudy: Talitha Dalton)

FOUR SEASONS – WINTER

WINTER LEAD:

Liliana Hale *(Understudy: Hope Acrey)*

WINTER DEMI-SOLOISTS:

Hope Acrey

Maya Al-Hmoud

Talitha Dalton

Bridget Mitchell

(Understudy: Catherine Lituania)

II. DETAILED REHEARSAL & PERFORMANCE SCHEDULES

PRE-THEATRE REHEARSAL SCHEDULE

January 20th – April 6th, 2024

Ballet Lubbock

IMPORTANT NOTES:

- All rehearsals through April 6th will be held at **BALLET LUBBOCK**.
- Rehearsals are in addition to normal class time. **Rehearsals are mandatory.**
- **Schedule subject to change.**
- Participants **MUST** be available for rehearsals at Ballet Lubbock for the dates and times listed.
- There will be a **mandatory** Costume Fitting on February 10th. All dancers are expected to attend.
- **Students may or may not be called for the entire block of time. A specific rehearsal schedule with times will be sent weekly to the students. Please reserve the hours of 12:00 pm to 6:00 pm for the Saturday rehearsals listed below.**

LEVEL 6

Saturday, February 10
Saturday, February 17
Saturday, February 24
Saturday, March 2
Saturday, March 9
Saturday, March 23
Saturday, April 6

LEVEL 7

Saturday, January 20
Saturday, January 27
Saturday, February 3
Saturday, February 10
Saturday, February 17
Saturday, February 24
Saturday, March 2
Saturday, March 9
Saturday, March 23
Saturday, April 6

LEVEL 8 AND COMPANY

Saturday, January 20
Thursday, January 25
Saturday, January 27
Thursday, February 1
Saturday, February 3
Thursday, February 8
Saturday, February 10
Thursday, February 15
Saturday, February 17
Thursday, February 22
Saturday, February 24
Thursday, February 29
Saturday, March 2
Thursday, March 7
Saturday, March 9
Thursday, March 21
Saturday, March 23
Thursday, March 28
Thursday, April 4
Saturday, April 6

We may call other performers to a Thursday evening rehearsal. Please watch your weekly schedules for these rehearsals.

<p align="center">COSTUME FITTING SCHEDULE</p> <p align="center">February 10th, 2024</p> <p align="center">Ballet Lubbock</p>
--

9:30 – 10:30	Level 6	<u>Attendants</u> (<i>Mia Adams, Variya Davis Cana Dalton, Angelica Guel, Maesyn Lane, Jessie Olivo, Hope Parker, Mamie Jane Rye, Ella Smith, Carly Soderstrum</i>)
10:30 – 11:30	Level 7	<u>Summer Corps</u> (<i>Jade Achin, Leilah Alvarez, Samantha Borrego, Nadia Byrd, Simeon Dalton, Charlee Kay Janyes, Audrey Oaks, Gemma Reber, Avett Reynolds, Ashlee Rodriguez, Marsali Soonpaa, Molly Thompson</i>)
11:30 – 12:00	Summer Leads	<u>Evelyn Fisher & Charity Neel</u>
12:30 – 1:30	Moonlight Fitting	<u>Company and Level 8 Understudies</u> (<i>Hope Acrey, Maya Al-Hmoud, Xaria Atienza, Talitha Dalton, Evelyn Fisher, Alexandria Flores, Liliana Hale, Brooke Lieberman, Catherine Lituania, Bridget Mitchell, Charity Neel, Noble Nguyen, Addison Reynolds, Katy Jane St. Clair, Kyrie Gutierrez, Viviana Luevano, Brynna Reimer, Emma Saculo</i>)
1:30 – 2:30	Level 8	<u>Autumn Corps and Lead</u> (<i>Katy Jane St. Clair, Kyrie Gutierrez, Julia Lopez, Viviana Luevano, Anna Belle Needham, Brynna Reimer, Ruth Rocha, Emma Saculo, Alexandra Wells</i>)
2:30 – 3:30	Spring	<u>Leads and Demi-Soloists</u> (<i>Alexandria Flores, Noble Nguyen, Xaria Atienza, Brooke Lieberman, Catherina Lituania, Addison Reynolds</i>)
3:30 – 4:30	Winter	<u>Leads and Demi-Soloists</u> (<i>Liliana Hale, Hope Acrey, Maya Al-Hmoud, Talitha Dalton, Bridget Mitchell</i>)

THEATER SCHEDULE

April 8th – 13th, 2024

Buddy Holly Hall of Performing Arts and Sciences

IMPORTANT NOTES:

- During this time, ALL rehearsals and performances will occur at **Buddy Holly Hall of Performing Arts and Sciences, 1300 Mac Davis Lane.**
- Please reserve these days and times.
- Levels 6, 7, and 8 will **NOT** have class as regularly scheduled on Monday, April 8th.

MONDAY, April 8 (Theatre) MOONLIGHT BLOCKING REHEARSAL

4:45 pm	Class	Company and Level 8 Understudies
6:00 pm	Dinner Break	
6:30 pm	Blocking of Moonlight	

TUESDAY, April 9 (Theatre) FOUR SEASONS BLOCKING REHEARSAL

4:45 pm	Class	Company
6:00 pm	Dinner Break	
6:00 pm	Call Time for those in The Four Seasons	Level 6 and Level 7
6:30 pm	Blocking of Four Seasons	Level 6, Level 7, Level 8, Company

WEDNESDAY, April 10 (Theatre) DRESS REHEARSAL (No make-up)

4:45 pm	Class	Company
6:00 pm	Dinner Break	
6:30 pm	Class	Level 6, Level 7, and Level 8
7:30 pm	Rehearse MOONLIGHT and FOUR SEASONS	

THURSDAY, April 11 (Theatre) TECHNICAL DRESS REHEARSAL

4:45 pm	Class	Company
6:00 pm	Dinner Break	
6:30 pm	Class	Level 6, Level 7, and Level 8
7:30 pm	Rehearse MOONLIGHT and FOUR SEASONS	

FRIDAY, April 12 (Theatre) TECHNICAL DRESS REHEARSAL

4:45 pm	Class	Company
6:00 pm	Dinner Break	
6:30 pm	Class	Level 6, Level 7, and Level 8
7:30 pm	Rehearse MOONLIGHT and FOUR SEASONS	

SATURDAY, April 13 (Theatre) EVENING PERFORMANCE

4:45 pm	Class	Company
6:00 pm	Dinner Break	
6:30 pm	Class	Level 6, Level 7, and Level 8
7:30 pm	Perform MOONLIGHT and FOUR SEASONS	

III. STUDENT INFORMATION

A. CHECK-IN/OUT LOCATIONS & PROCEDURES

- All dancers will enter through the Ballet Lubbock Main Entrance. (*see map pg. 12*)
- Only Company students are allowed to “Meet and Greet” the audience in costume after each performance. All other students will return immediately to their dressing rooms. Each student must change out of their costume and respectfully put it away before leaving the dressing room.

B. NEEDS AT BUDDY HOLLY HALL

- Warm clothing to wear over leotard and tights.
- Water bottle. Water is allowed in the dressing rooms, but is not to be consumed while in costume.
- Students should eat before arriving at Buddy Holly Hall. Food of any kind is not allowed in the dressing rooms, and students will be present for extended periods during rehearsals and performances. **ALERT: Students should not consume peanut products just prior to arrival at the theatre due to the severe, life-threatening allergies of some students. Even the slightest transfer of peanut residue can trigger an allergic reaction in some students.**
- Label all belongings: shoes, bags, jackets, leotards, etc.
- Buddy Holly Hall and Ballet Lubbock are NOT responsible for lost or stolen items. Use discretion if bringing valuable items.
- Ensure students are rested throughout theatre week. Encourage students to rest after school before coming to the theatre, as rehearsals and performances can extend into later evening hours.
- Encourage students to hydrate throughout the week. Heavy meals prior to performing are not recommended. Milk and egg products are especially not recommended. Fruit, pasta, vegetables, crackers and bagels are good energy foods that are light on the stomach.
- **If your student is exhibiting a fever, runny nose, vomiting, diarrhea, loss of sense of taste, loss of sense of smell, or body aches do not come to the theatre, as this puts all other performers at risk for illness. Please email/text Micah Gonzales (production@balletlubbock.org)/(806-790-5401) to report an absence.**
- **For more health protocols, please refer to the following link on the Ballet Lubbock website:**
https://www.balletlubbock.org/_2022/wp-content/uploads/2022/01/Ballet-Lubbock-Health-Protocols-01_20_22.pdf

C. COSTUME, MAKEUP & HAIR ASSIGNMENTS

- All costumes belong to Ballet Lubbock and are used for multiple years. Many are delicate and hand sewn. Please tell students to carefully respect their costume.
- No student is to leave the dressing room area or backstage area in costume.
- Hair and makeup are to be done prior to arrival at the theatre.
- Ballet Lubbock will supply costumes. Listed below is what students must supply.

Moonlight Company:

Female Dancer provides: Nude leo, pink tights, pink pointe shoes

Male Dancer provides: Class uniform, tights and shoes TBD

Hair & Makeup: Balanchine bun and standard stage make-up

Ballet Lubbock provides: TBD

Level 6 Attendants:

Female Dancer provides: Nude leo, tights TBD, flat ballet shoes

Hair & Makeup: Balanchine bun and standard stage make-up

Ballet Lubbock provides: TBD

Level 7 Summer Corps:

Female Dancer provides: Nude leo, tights TBD, pink pointe shoes

Male Dancer provides: Class uniform, tights and shoes TBD

Hair & Makeup: Balanchine bun and standard stage make-up

Ballet Lubbock provides: TBD

Level 8 Autumn Corps:

Female Dancer provides: Nude leo, tights TBD, pointe shoes

Hair & Makeup: Balanchine bun and standard stage make-up

Ballet Lubbock provides: TBD

The Four Seasons Company:

Female Dancer provides: Nude leo, tights TBD, pointe shoes

Hair & Makeup: Balanchine bun and standard stage make-up

Ballet Lubbock provides: TBD

Company The Four Seasons Leads and Demi-Soloists:

Female Dancer provides: Nude leo, tights TBD, pointe shoes

Hair & Makeup: Balanchine bun and standard stage make-up

Ballet Lubbock provides: TBD

IV. GENERAL INFORMATION

A. ATTENDANCE OF THEATRE REHEARSALS

- Rehearsals in the theatre during Theatre Week are closed.
- Parents not scheduled to volunteer or those not attending a performance but waiting on a student are asked to wait in the Ballet Lubbock parking lot or return at the assigned pick-up time. Thank you for respecting these rules, as well as the volunteers in charge.
- Parents not assigned a backstage pass may not proceed past the backstage check-in area. There will be a volunteer at the check-in desk who can contact those in the backstage area if necessary. Under no circumstance are any parents or volunteers allowed to enter the stage or theatre areas. Only Buddy Holly Hall personnel, stage crew, and Ballet Lubbock production personnel are permitted backstage.

B. TICKET INFORMATION

- To purchase tickets please visit www.balletlubbock.org or <https://www.buddyhollyhall.com>
- You may also call (806) 79-BUDDY (792-8229) or visit in person at the Buddy Holly box office, located at 1300 Mac Davis Lane, Lubbock, TX 79401.
- The Buddy Holly Hall does NOT allow children to sit on an adult's lap. **Each person MUST have a seat/ticket.**

C. PHOTOGRAPHY & VIDEO INFORMATION

- Due to safety concerns and copyright protection, photography and videotaping of any rehearsal or performance in the theater is strictly prohibited. Performers can be distracted and therefore seriously injured by flash photography.
- For privacy purposes, dancers are strictly prohibited from taking any kind of photography or videography in the dressing rooms. Devices can be confiscated if this guideline is not followed.

D. BUDDY HOLLY HALL INFORMATION

- Please review the following to familiarize your family with the policies and protocols of Buddy Holly Hall:
<https://www.buddyhollyhall.com/guest-safety/>
<https://www.buddyhollyhall.com/know-before-you-go/>
<https://www.buddyhollyhall.com/facility-cleanliness-and-guest-health/>

Buddy Holly Hall Rear West Door

Ballet Lubbock Main Entrance

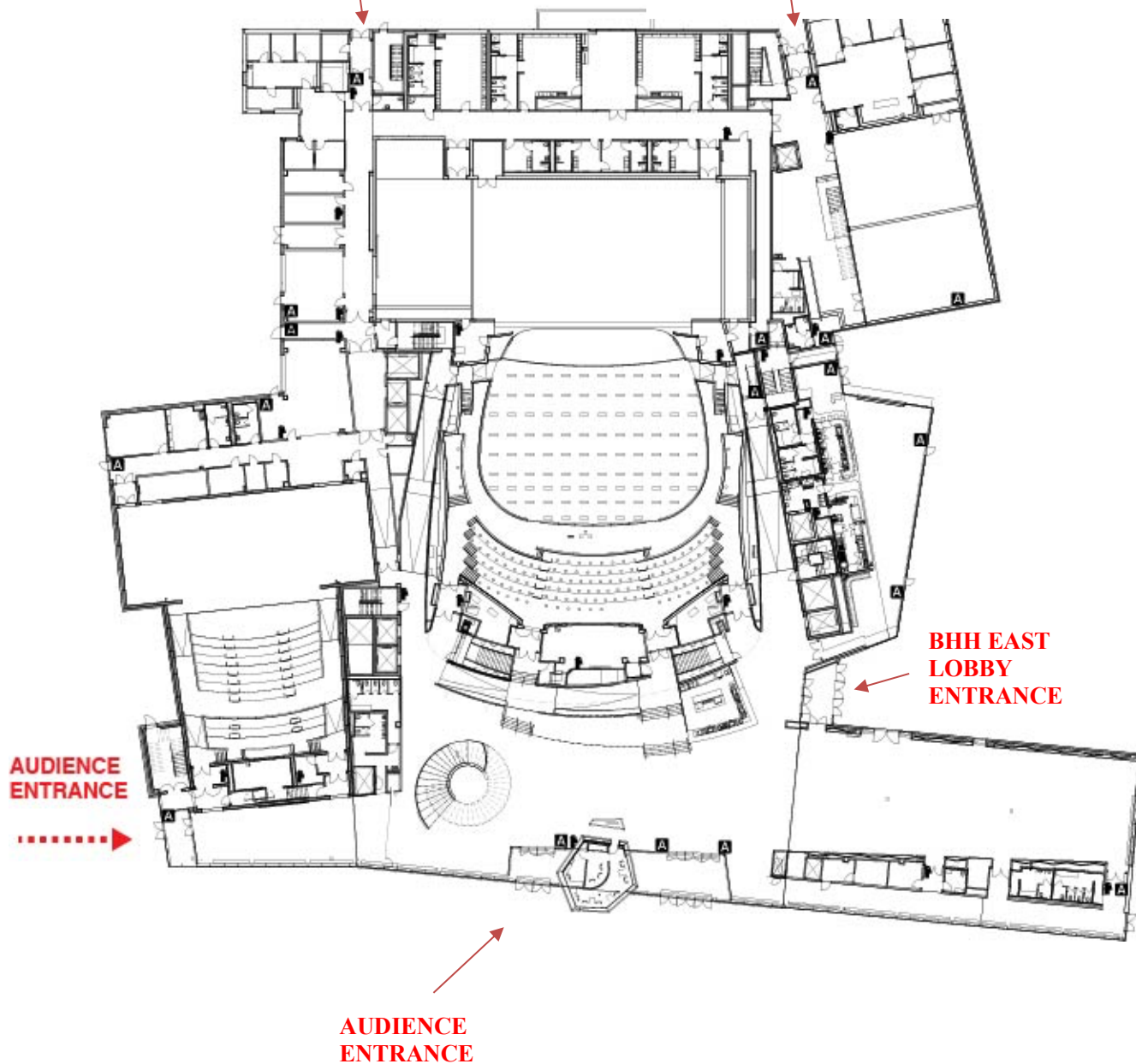

BACKSTAGE DRESSING

ROOMS:

- Level 6/Level 7 - A16
- Level 8 - B16
- Company Females - A14
- Noble, Avett, Simeon - D
- Costume Staff - B
- Costume Staff - C
- *Dancers please enter through Ballet Lubbock Main Entrance*

NOTES
